



# SANDON MANOR

An exclusive, luxury wedding venue



---

TASTEFULLY TRADITIONAL OR DAZZLINGLY  
DIFFERENT, SANDON MANOR WEDDING  
VENUE IS A MAGICAL CANVAS ON WHICH  
TO CREATE YOUR DREAM WEDDING

---





Liz Greehalgh

## WELCOME TO SANDON MANOR

Sandon Manor offers exclusive use of all of the accommodation and grounds for your special wedding stay. Have your wedding at Sandon Manor, an environmentally sustainable venue providing a large space for nature.

**Wedding Venue** – celebrations for up to 150 people in Sandon Manor's exclusive wedding venue. Offering flexibility for your bespoke day in the Medieval Barn, East Wing Ceremony Hall, Hay Barn and fully equipped commercial kitchen all set around the historic courtyard.

**Manor House** – intimate weddings for up to 18 residents staying on site.



Laura Williams





Liz Greehalgh

## WEDDING VENUE

Exquisite weddings for up to 150 guests. The Medieval Barn forms the centrepiece of our bespoke wedding venue. Built out of English Oak in 1266 and sensitively converted by a RIBA award-winning architect for exquisite weddings; complete with cocktail bar, dance floor and bespoke sound and light system. Take your vows under The Courtyard Summerhouse followed by drinks in the Hay Barn and if British weather intervenes you'll be covered by our Ceremony Hall.

- East Wing Ceremony Hall - licenced for civil ceremonies
  - Panelled walls & polished concrete floor
  - Fantastic natural light with foliage
  - Amazing acoustics
- Courtyard - mixture of paving, beds with greenery, lighting, fragrant flowers and evergreen plants
  - Licensed for outdoor civil ceremonies
  - For sunny reception drinks
  - Verandas and Olive trees for shade and shelter
- Haybarn for wet weather receptions
  - Flexible space
  - With bar
- Medieval Barn - with historic oak beams, underfloor heating, polished concrete floor, air conditioning system, mood lighting to suit your colour scheme
  - Dance floor with inbuilt bespoke light and sound system
  - With evening cocktail bar - copper top, green tiled
- Kitchen building with commercial Kitchen



## INTIMATE WEDDINGS AT SANDON MANOR

Intimate weddings are available in the Manor House. Stay with 18 of your closest friends and family in stunning Sandon Manor and the Dovecote. Built in 1661, Sandon Manor is the centrepiece of your intimate wedding. Take your vows in front of the beautiful winding staircase, then open the front doors and treat your guests to bubbles on the lawn followed by a celebration feast in the dining room, with seasonal local produce sourced from our outstanding suppliers.

Wild ceremony locations available around Sandon Estate.



Laura Williams



Laura Williams



# A WEDDING BANQUET TO REMEMBER

## FEAST & CELEBRATE

The 800 year-old medieval barn forms the backdrop to your wedding feast where up to 150 guests can dine in comfort. This atmospheric space was recently converted and also contains a cocktail bar and bespoke dance floor with state of the art sound and lighting.

If you prefer a more intimate setting 18 guests can dine at Sandon Manor in the 16th century dining room.

Sandon Manor works closely with a selection of outstanding local caterers inspired by local produce and seasonal menus. Catering can be provided outside or inside depending on your preference and the weather.



Liz Greehalgh



Liz Greehalgh



Liz Greehalgh





Laura Williams



## WEDDING STAYS

Stay, relax, share stories and laughter with family and friends making memories over your wedding stay. We never rush you on the most important day of your lives, we give you time to enjoy your wedding to the full, whilst staying in historic, stylish Sandon Manor, and the romantic Dovecote honeymoon suite.













Laura Williams

## A WILDER SPACE FOR NATURE

Immerse yourselves in 1000 acres of wilder nature in the re-wilded reserves on Sandon Manor Estate. Roam through the kaleidoscope of habitats - home to birds, bees, butterflies and insects.

Let us host you during your stay with our experiences in secluded areas on the estate - The woodlands, orchards and wildflower meadows provide the backdrop to our residents activities which include floral design, wild dining, art and baking as well as wellness activities; yoga, pilates, massage with healthy meal options.

When you stay here you will be able to explore this special place on one of the many footpaths that cross the estate.



Laura Williams



Laura Williams



## WEDDING VENUE HIGHLIGHTS



### Beautiful accommodation

On site for up to 18 guests



### Multiple options for your wedding ceremony

A blank canvas for your special day



### Feast and celebrate in the Medieval Barn

Recently converted with modern features to create a comfy, formal and stylish setting for your celebration



### Dance floor

Located within the Medieval Barn, a space to party and dance the night away with a relaxed atmosphere for those who want to chat by the bar



### Stunning Dovecote Honeymoon Suite

Cozy and stylish with unique character



### Drinks reception

In Sandon Manor grounds in front of the parterre, the courtyard, or for wet weather The Haybarn Bar. Getting ready suite available to hire for up to 10 people

## CATERERS

**Cambridge Dining Company** - [www.cdc.events](http://www.cdc.events)

**Carte Blanche** - [www.carteblanhecatering.co.uk](http://www.carteblanhecatering.co.uk)

**Portfolio Events Catering** - [www.portfolioevents.com](http://www.portfolioevents.com)

If you require an alternative caterer for religious purposes please get in touch and we can provide you with details

Please see separate list for recommended suppliers

## PRICING

The cost for your wedding depends on the time of year and the day or the week. please see separate price list.

Sandon Manor also offers holidays and company stays.



Liz Greehalgh



SANDON MANOR



WEDDINGS  
HOLIDAYS  
RETREATS  
COMPANY STAYS  
CREATIVE RESIDENCIES  
FILM LOCATIONS  
CONFERENCES

All at this stunning location



01763 284 067  
[info@sandonmanor.com](mailto:info@sandonmanor.com)  
ig: @sandonmanor



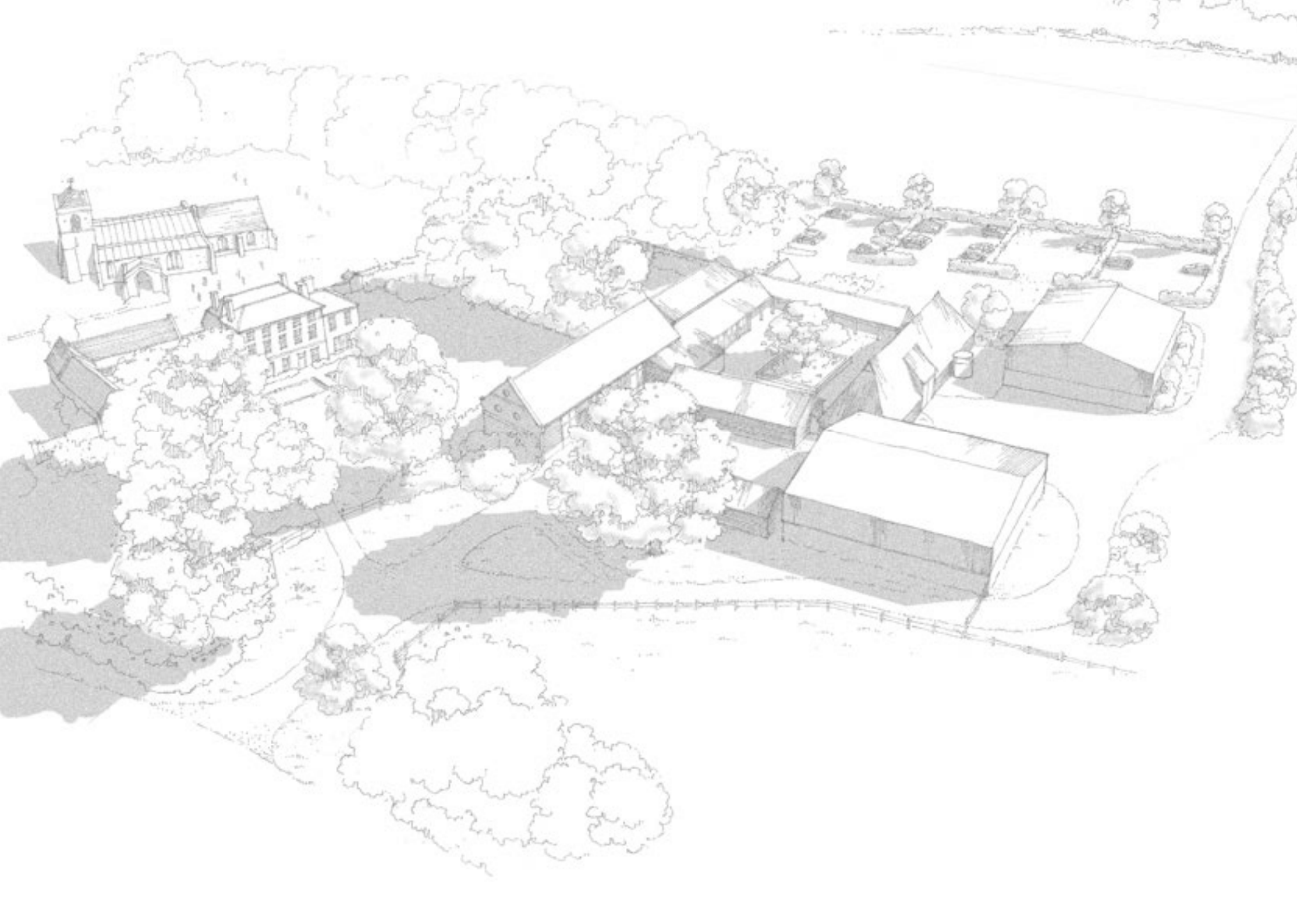

---

AN ENCHANTING COUNTRY  
ESCAPE NESTLED AMIDST 1,200  
ACRES OF ROLLING COUNTRYSIDE

---





[www.sandonmanor.com](http://www.sandonmanor.com)

01763 284 067

[info@сандонманор.ком](mailto:info@сандонманор.ком)

ig: @сандонманор

Sandon Manor, Sandon Bury Farm  
Sandon, Buntingford, SG9 0QY